

Technical Bulletin

| | |
|-----------|---------------------|
| REFERENCE | TB_2022_FRECA_01_EN |
| DATE | 2022-03-08 |
| SUBJECT | Update regulations |

a. Article 2.7.2 Standard mounting parts :

Standard mounting parts, such as screws, nuts, bolts, washers and lock washers, are considered as Type 3 parts unless specifically mentioned in the homologation. They may be replaced with equivalent or superior standard parts.

The thread type, size, **length** and pitch must remain the same.
Threads may be repaired provided that they are not connected to Type 1 screws, nuts or bolts.

The use of locking wire is permitted.

Any type of standard mounting part which has an influence on the car set-up is considered as a Type 1 part unless specifically mentioned in the homologation.

Only Type 3 washers may be removed.

Washers may be added only for facilitating and improving mechanical installation. They may influence the set-up of the car only when specifically mentioned in the homologation.

b. Article 2.7.6 Miscellaneous

Electrical loom

All the loom connectors must be connected on their respective sensors.

c. HALO :

It is not allowed to grind or modify the Halo structure to improve its aspect
Painting the Halo is allowed, although the label with the homologation number must not be painted / covered with colouring film
No reflective paint must be applied to the Halo on the areas visible by the driver when seated in the car.

Nomenclature (release 4.1.1)

01A – Chassis

Item 8 (Mirror Stem Assy)

Only reference **TM01009** is allowed.
The stem cannot be cut and must respect the dimensions above.

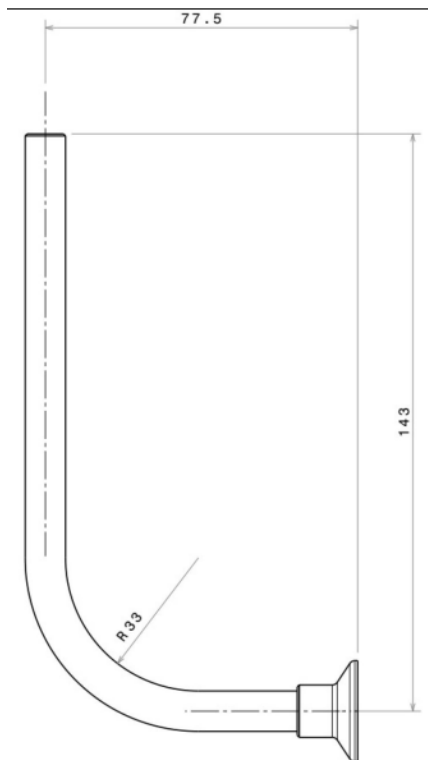

TM01009

02E – Bodywork

Item 6 and 7 (Sidepod Wing)

It is allowed to stick a spacer with a maximum height of 20 mm.
This spacer will increase the link between the sidepod wing and the pin item 9.

Item 10 and 11 (Lh and Rh louvered panel)

It is allowed to use only adhesive tape by the underside of each sidepods gills as blanking.
It must not join several bodywork parts.

Item 23 (engine cover)

It is allowed to drill an opening for the camera wire on the engine cover top (near the rollbar).

10A - Front wishbone / 10C Front lower Wishbone

Item 1: Front wishbone

It is allowed to improve the fastening and the protection of wheel tether and hoses along the wishbone using a fairing protection or black tape mandatory.

This protective cover must be made either in plastic or in composite material and must be fitted on the wishbone using black tape. The overall length of one side of triangle on the side of the protective cover surface shall not exceed a maximum of 70 mm as shown below.

The overall height shall not exceed a maximum of 27 mm as shown below.

Item 4: Wheel tether

It is allowed to tie down and protect these cables on the wishbones with a fairing or adhesive tape. Only black tape may be used.

It is compulsory to change the front tether rope as soon as the outer cover is torn.

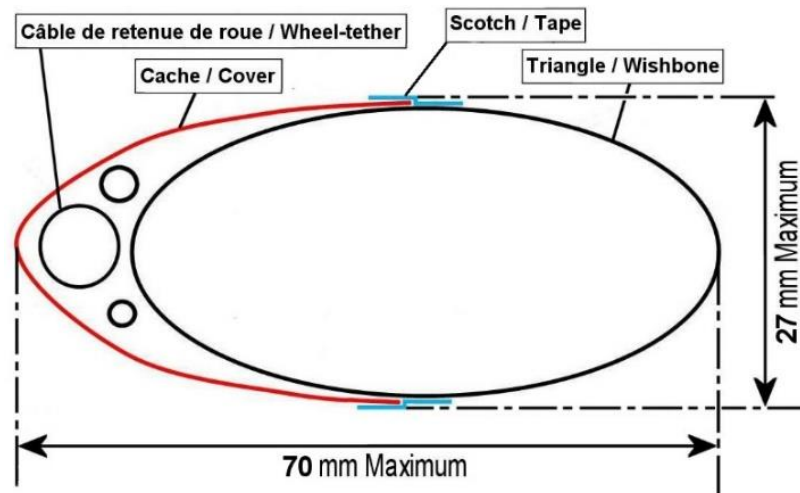

10B Front push rod / 14E Rear push rod :

Item 3-4-5-6-7 (10BA) / Item 3-4-5-6-7 (14E) : Push rod spacer

It's allowed to paint the push rod spacer.

12A Front upright / 16B Rear upright :

Item 19 (12A) / Item 4 (16B) : Wheels

It's not allowed to paint the wheels.

Item 14 (12A) / Item 3 (16B) : (Brake pads)

Only the Brembo brake pads are allowed.

12A Front upright / 16B Rear upright :

Item 19 (12A) / item 4 (16B) : Wheels

It is allowed to sandblast your wheels (Front and rear). The maximum sandblasting area is defined in the drawing (see below). This modification is not mandatory.

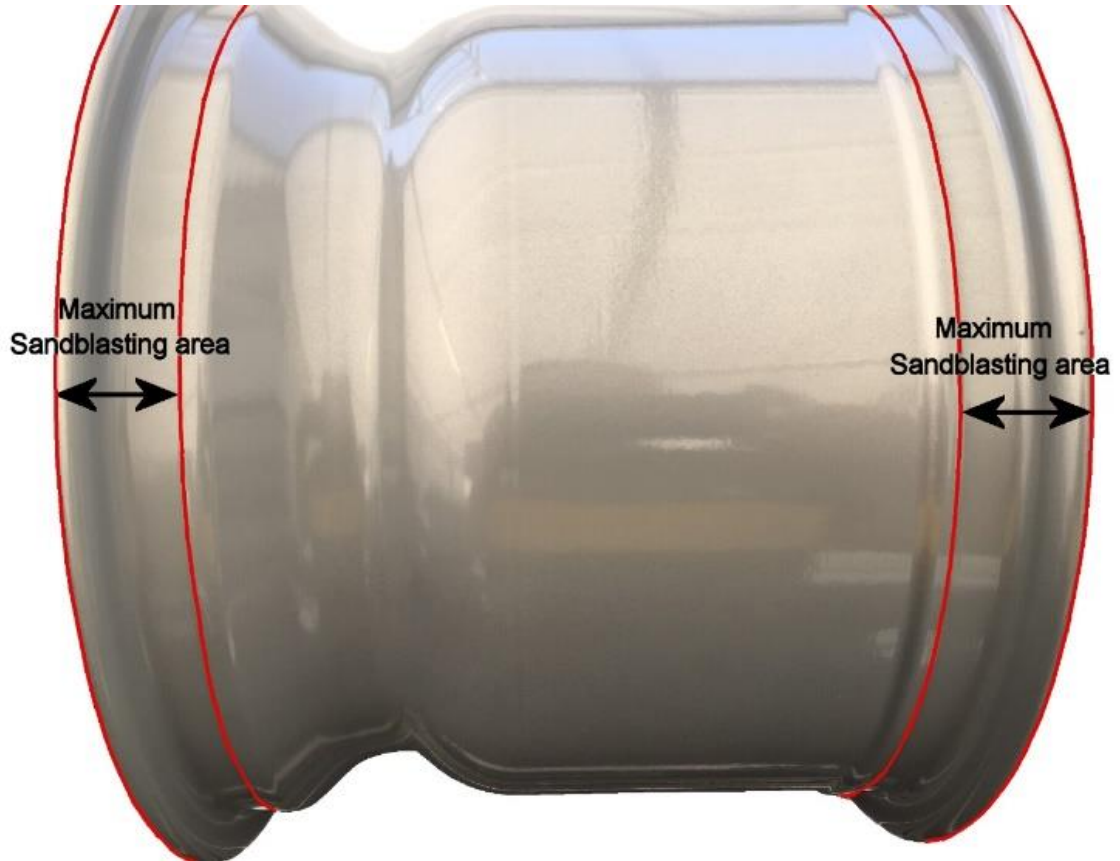

14A Rear upper wishbone / 14D Rear lower Wishbone

Item 1 (14A) / item 1 and 2 (14D) : Rear wishbone

It is allowed to improve the fastening and the protection of wheel tether and hoses along the wishbone using a fairing protection or black tape mandatory.

This protective cover must be made either in plastic or in composite material and must be fitted on the wishbone using black tape. The overall length of one side of triangle on the side of the protective cover surface shall not exceed a maximum of 70 mm as shown below.

The overall height shall not exceed a maximum of 27 mm as shown below.

Item 4 (14A) / Item 6 (14D) : wheel tether

It is allowed to tie down and protect these cables on the wishbones with a fairing or adhesive tape. Only black tape may be used.

It is compulsory to change the front tether rope as soon as the outer cover is torn.

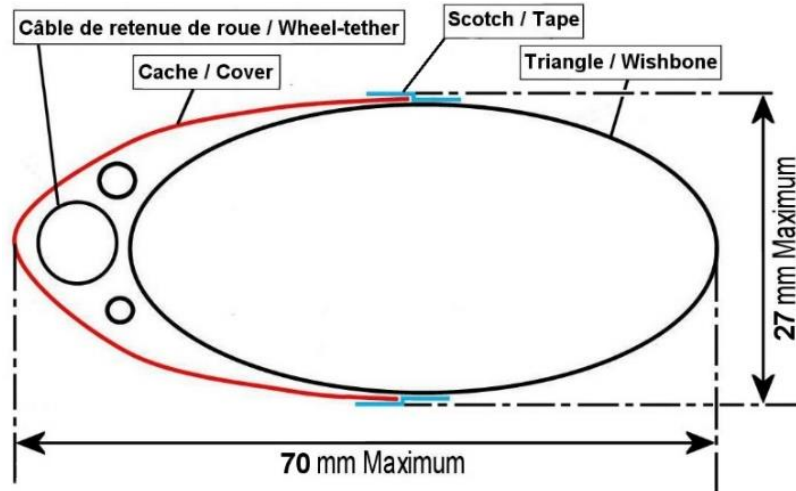

26B Data System :

Item 7-8 : GPS antenna

It's allowed to adjust the length of the wiring loom of the GPS antenna.

26D Video System :

Item 7

Two video camera kits are allowed :

- AIM Smarty Cam 2.1
- AIM Smarty Cam 2.2.

It's compulsory to use the optional parts. Item 0 ; 7 ; 12 ; 13 ; 14

30F Gearbox :

Items 7 (23/29) ; item 9 (26/28) ; item 10 (25/25) ; item 11 (23/20) : **Options not allowed**

30G Gearbox :

Items 5 (23/20) ; item 8 (25/25) ; item 10 (26/28) ; item 11 (23/29) : **Options not allowed**

32 Gearbox cooling

Items 1

It is allowed to use blanking on the gearbox oil radiator.

42B Engine Lubrification Renault :

Item 7 : Filter

It's allowed to improve the air filter fixation following the procedure see below.

- Stick a TC 105 bracket on the top of the filter.
- Put a tyrap between the part #2 and the bracket sticked on the filter (see pictures).

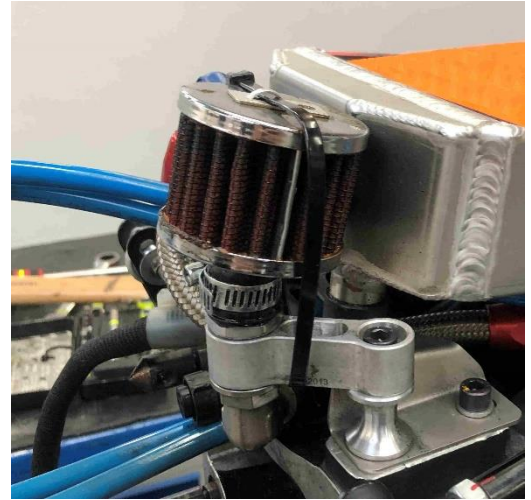

43 Air System Renault

Items 1 and 2 :

It is forbidden to put a thermal protection on the intercooler (item 1) and on the air intake pipe (item 2).

Turbo and exhaust manifold thermal protection (Renault MR18 FR Engine, November 20th 2020 release) :

12.00 (Item 3), 12.10 (Item 1) :

It's forbidden to put a thermal protection on the turbo and the exhaust manifold.

12.10 (Item 3) :

To assure the tightning of the screws, the use of locking wire is permitted.